

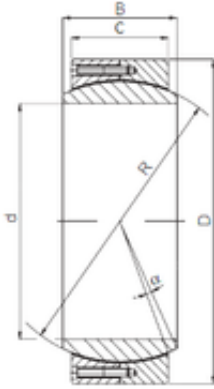

Timken BEARINGS INDUSTRY

380 mm x 520 mm x 190 mm ISO GE 380 QCR
plain bearings



Bearing No. GE 380 QCR

Size	380x520x190 mm
Bore Diameter	380 mm
Outer Diameter	520 mm
Width	190 mm
d	380 mm
D	520 mm
B	190 mm
C	160 mm
R	450 mm
Angle	4,1 °

GE 380 QCR Bearing 2D drawings and 3D CAD models